

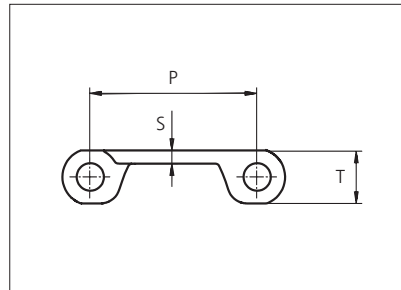

# Plastic Modular Belt

Series **uni BLB** Type **18% Open**

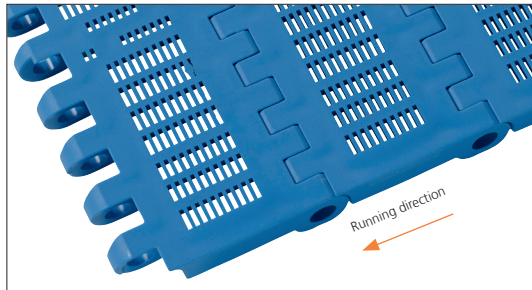

Straight running belt  
 Nominal pitch: 50.8 mm (2.00 in)  
 Surface type: Flat  
 Surface opening: 18%  
 Backflex radius: 65.0 mm (2.60 in)  
 Pin diameter: 8.0 mm (0.31 in)

Belt material & color	PP-HW <b>LB</b>		mm	in		mm	in
	Pin and lock material & color	<b>SS304</b> <b>PP-HW LB</b>	<b>P (Nominal)</b>	50.8	2.00	<b>T</b>	16.0
<b>S</b>			4.0	0.16	-	-	-

Non standard material and color: See uni Material and Color Overview.

Alternative pin and lock materials: Lockpin: PP-HW **LB**

Belt width		***Permissible tensile force (Belt/pin material)				Belt weight (Belt/pin material)				*Min. No. drive sprocket per shaft	Number of wear strips (Min. No.)	
		PP-HW/SS		PP-HW/ PP-HW		PP-HW/SS		PP-HW/PP-HW			**Carry (pcs)	**Return (pcs)
mm	in	N	lbf	N	lbf	kg/m	lb/ft	kg/m	lb/ft			
153	6.0	1010	227	1010	227	1.8	1.20	0.7	0.49	2	2	2
306	12.0	2020	454	2020	454	3.6	2.41	1.5	0.99	3	3	2
357	14.0	2354	529	2354	529	4.2	2.80	1.7	1.15	3	3	2
408	16.1	2693	605	2693	605	4.8	3.21	2.0	1.32	3	3	2
459	18.1	3028	681	3028	681	5.4	3.61	2.2	1.48	4	4	2
509	20.1	3362	756	3362	756	6.0	4.01	2.4	1.64	4	4	2
560	22.1	3697	831	3697	831	6.6	4.40	2.7	1.81	4	4	2
611	24.1	4032	906	4032	906	7.1	4.80	2.9	1.97	5	5	3
662	26.0	4367	982	4367	982	7.7	5.20	3.2	2.13	5	5	3
713	28.1	4706	1058	4706	1058	8.3	5.61	3.4	2.30	5	5	3
764	30.1	5041	1133	5041	1133	8.9	6.01	3.7	2.46	6	6	3
815	32.1	5379	1209	5379	1209	9.5	6.41	3.9	2.63	6	6	3

Additional standard belt widths are available in steps of 50.7 mm (2.00 in).

1985	78.1	13101	2945	13101	2945	23.2	15.61	9.5	6.40	14	14	7
------	------	-------	------	-------	------	------	-------	-----	------	----	----	---

Additional standard belt widths are available in steps of 50.7 mm (2.00 in).

3003	118.2	19820	4455	19820	4455	35.1	23.61	14.4	9.69	21	21	11
------	-------	-------	------	-------	------	------	-------	------	------	----	----	----

General belt tolerance is +0/-0.4% at 23°C/73°F and 50% RH. For exact belt width contact Customer Service. Non standard belt width on request.

\*Max. Load per Drive Sprocket. Belt material: PP-HW with snub roller 2000 N (450 lbf), PP-HW without snub roller 1250 N (281 lbf).

\*\*Max. Spacing between wear strips, Carry: 152.0 mm (6.00 in); Return: 304.0 mm (12.00 in).

\*\*\*Load capacity per row of reinforcement links in the belt: 2500 N (562 lbf).

\*\*\*Example: Belt with 8 rows of reinforcement links, permissible load is 8 x 2500 N (562 lbf) = 20000 N (4496 lbf).

= Single Link



STANDARD

STRAIGHT RUNNING

PITCH 50.8 MM/2.00 IN

## Accessories

### Flight / Non Standard

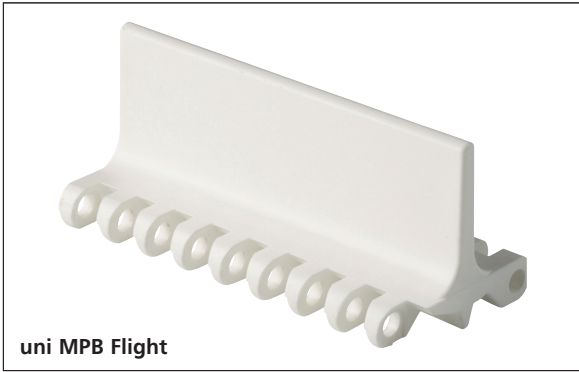

uni MPB Flight

uni MPB Flights in PP-HW **LB** fits the BLB belt and are available on request. Please see the uni MPB Flight datasheet for more information.

## Accessories

### Side Guard

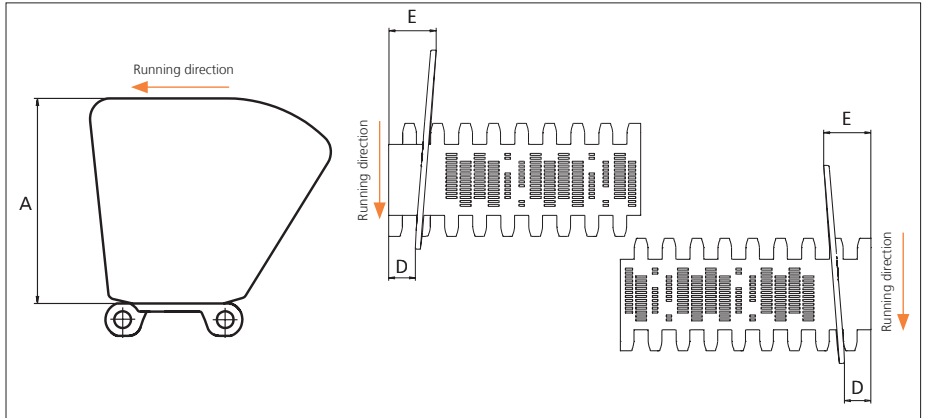
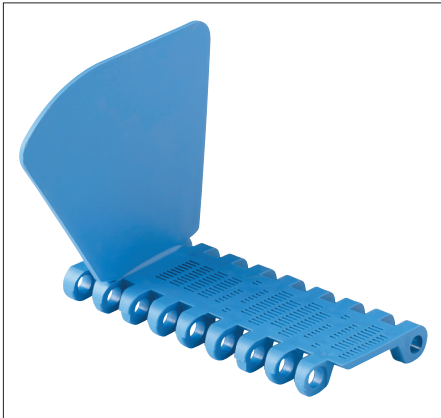

Type	Material & color	A		E		D	
		mm	in	mm	in	mm	in
Closed	PP-HW <b>LB</b>	101.6	4.00	28.5	1.12	16.0	0.63

Non Standard material and color: See uni Material and Color Overview.  
Backflex radius for Side Guard: 200.0 mm (7.90 in)

## Accessories

### Reinforcement Link



Type	Material & color	N/row load cycles	Lbf/row load cycles
Steel Link	<b>SS316</b>	1500	337
		2500	562

Photo is showing uni BLB 18% Open with reinforcement links in two rows, surface is the same for uni BLB 22% Open and uni BLB 38% Open.

Non Standard material and color: See uni Material and Color Overview.

Load capacity per row of reinforcement links in the belt. Maximum 19 rows per metre belt width.

Example: If seven rows are installed the max. permissible load of the belt is  
7 x 2500 N (562 lbf) = 17500 N (3934 lbf).

## Sprocket

No of teeth	Bore size								Overall diameter		Pitch-diameter		Hub-diameter		Dimension A		Dimension B		Single row/One way	Molded	Machined	
	Pilot bore	in			mm			60.0														63.5
		mm	25.4	30.0	31.8	38.1	40.0		2.36	2.50												
Z08	✓	●	●	●	■	■				132.9	5.23	132.8	5.23	65.0	2.56	53.3	2.10	74.9	2.94	✓	✓	
Z10	✓		●	●	■	■				166.3	6.55	164.4	6.47	65.0	2.56	70.2	2.76	90.7	3.57	✓	✓	
Z10							■	■		166.3	6.55	164.4	6.47	120.0	4.72	70.2	2.76	90.7	3.57	✓	✓	
Z12	✓		●	●	■	■				198.6	7.82	196.3	7.73	65.0	2.56	86.8	3.42	106.6	4.19	✓	✓	
Z12							■	■		198.6	7.82	196.3	7.73	120.0	4.72	86.8	3.42	106.6	4.19	✓	✓	
Z16	✓		●	●	■	■	■	■		263.8	10.39	260.4	10.25	150.0	5.90	119.7	4.71	138.7	5.46	✓		✓

● Molded sprocket

■ Machined sprocket

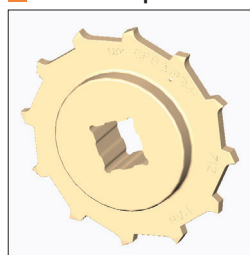
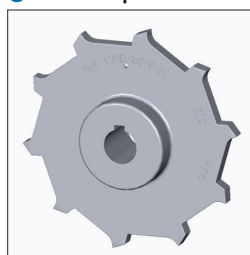

Other sprocket sizes are available upon request.

Other bore sizes on sprockets are available upon request.

Max. load per sprocket shown does not take bore size into account.

Please also ensure that sufficient size shaft is chosen for corresponding load.

Width of tooth = Single row: 9.5 mm (0.37 in)

Width of One-part sprocket = Single row: 42.3 mm (1.67 in)

## uni UltraClean One-Part and Two-Part Sprocket

No. of teeth	Bore size				Overall diameter		Pitch-diameter		Hub-diameter		Dimension A		Dimension B		Single row/One way	Molded
	in		mm													
	1.50	1.57	2.36	mm	in	mm	in	mm	in	mm	in	mm	in			
Z8	1	2	1	2					165.0 277.0	12.56 23.03	53.3	2.10	74.9	2.94	✓	✓
Z10	1	2	1	2	2				165.0 2126.0	12.56 24.96	70.2	2.76	90.7	3.57	✓	✓
Z12	1	2	1	2	2				165.0 2126.0	12.56 24.96	86.8	3.42	106.6	4.19	✓	✓

■ Molded uni UltraClean OnePart Sprocket

■ Molded uni UltraClean TwoPart Sprocket

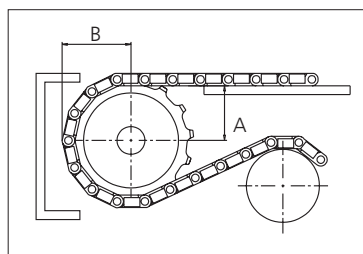
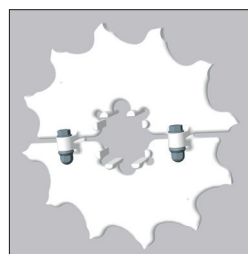
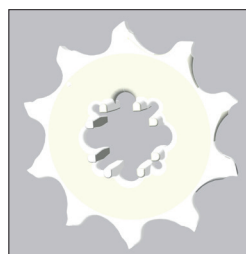

Width of UltraClean Two-part sprocket

= Single row: 44.0 mm (1.73 in)

Width of UltraClean Two-part sprocket, tooth

= Single row: 9.5 mm (0.37 in)

uni Retainer Rings: See uni Retainer Ring datasheet.

For correct sprocket position:

See uni Assembly instructions for uni MPB.

More detailed sprocket information:

contact Customer Service.

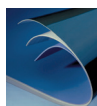

Synthetic Belts



Endless Woven Belts

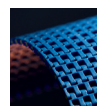

Modular Belts

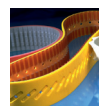

Engineered Belts



Homogeneous Belts



Fabrication & Service

Expert advice and quality solutions for all your belting needs.

ammeraalbeltech.com  
eptoolonline

Ammeraal Beltech Modular A/S

Hjulmagervej 21  
DK-7100 Vejle  
T +45 7572 3100

ammerga.com

This information is subject to alteration due to continuous development. Ammeraal Beltech will not be held liable for the incorrect use of the above stated information. This information replaces previous information. All activities performed and services rendered by Ammeraal Beltech are subject to general terms and conditions of sale and delivery, as applied by its operating companies.

Member of Ammega Group.